

This all 316L stainless steel meter utilizes a float and tapered tube design which offers longer, more linear scales, better pointer stability and 40% greater accuracy than competitively priced products. A 4-20mA transmitter option adds to its versatility.

## New Indicator Housing!



### DESCRIPTION

<b>Metering Tube</b>	316L SS
<b>Internal Components</b>	316L SS
<b>Fitting Material</b>	316L SS
<b>Inlet/Outlet Fittings</b>	316L SS NPT or flange, vertical
<b>O-Ring</b>	Standard: Viton® Optional: Buna N, EPR, Kalrez®
<b>Indicator Housing</b>	Die-cast Aluminum / Powder Coated with Chemfilm base (RoHS Compliant)

### PERFORMANCE

<b>Capacities</b>	Water 33 GPH to 450 GPM Air 4 to 100 SCFM
<b>Scale</b>	120 mm direct reading, detachable
<b>Accuracy</b>	± 3% of full scale flow
<b>Turndown</b>	10:1
<b>Repeatability</b>	1 %
<b>Maximum Temperature</b>	<b>O-Ring Material</b> <b>Max Temperature</b> EPR 225° F (107° C) Buna-N 275° F (135° C) Viton® 350° F (177° C) Kalrez® 400° F (204° C)
<b>Maximum Pressure</b>	NPT fittings 1,500 psi SS flange class <b>Temp F</b> <b>150#</b> <b>300#</b> <b>600#</b> 200° 225 psi    600 psi    1,200 psi 300° 200 psi    540 psi    1,100 psi 400° 180 psi    515 psi    1,000 psi
<b>Ambient Temperature</b>	-40° F to 125° F (-40° C to 52° C)

### OPTIONS

<b>Alarm</b>	Single or dual, Inductive Slot Sensor 4-20 mA transmitter
<b>Certified Calibrations</b>	Conform to ISA RP 16.6
<b>CRNs</b>	All Canadian provinces
<b>Scales</b>	Any volumetric unit



29 Riel Drive, St. Albert, AB., Canada T8N3Z2  
Ph: 780-459-7080 • Fax: 780-459-7085  
Toll Free: 1-800-661-8823  
www.muiscontrols.com • info@muiscontrols.com

Order Number	Full Scale Flow GPM-Water	Dimension (Inches) FNPT Connections						150 # Flange		300 # Flange	
		A	B	C	D	E	F	G	H	G	H
706	33.0 GPM – 1/2" FNPT	1.30	11	4.32	4.8	3.92	4.87	3.50	13.125	3.75	13.625
708	1.1 GPM – 1/2" FNPT	1.30	11	4.32	4.8	3.92	4.87	3.50	13.125	3.75	13.625
710	2.0 GPM – 1/2" FNPT	1.30	11	4.32	4.8	3.92	4.87	3.50	13.125	3.75	13.625
712	4.0 GPM – 1/2" FNPT	1.30	11	4.32	4.8	3.92	4.87	3.50	13.125	3.75	13.625
714	6.0 GPM – 1/2" FNPT	1.30	11	4.32	4.8	3.92	4.87	3.50	13.125	3.75	13.625
716	5.0 GPM – 1" FNPT	1.88	13.24	4.86	4.8	4.50	4.87	4.25	16.75	4.88	17.500
718	10.0 GPM – 1" FNPT	1.88	13.24	4.86	4.8	4.50	4.87	4.25	16.75	4.88	17.500
720	16.5 GPM – 1" FNPT	1.88	13.24	4.86	4.8	4.50	4.87	4.25	16.75	4.88	17.500
722	25.0 GPM – 1" FNPT	1.88	13.24	4.86	4.8	4.50	4.87	4.25	16.75	4.88	17.500
724	35.0 GPM – 1 1/2" FNPT	2.34	13.864	5.24	4.8	4.96	4.87	5.00	18.625	6.12	19.250
726	60.0 GPM – 1 1/2" FNPT	2.34	13.864	5.24	4.8	4.96	4.87	5.00	18.625	6.12	19.250
728	76.0 GPM – 2" FNPT	3.46	13.875	6.35	4.8	6.08	4.87	6.00	17.156	6.50	17.786
730	100.0 GPM – 2" FNPT	3.46	13.875	6.35	4.8	6.08	4.87	6.00	17.156	6.50	17.786
732	120.0 GPM – 2" FNPT	3.46	13.875	6.35	4.8	6.08	4.87	6.00	17.156	6.50	17.786
734	152.0 GPM – 2" FNPT	3.46	13.875	6.35	4.8	6.08	4.87	6.00	17.156	6.50	17.786
736	150.0 GPM – 3" Flange	4.46	—	7.26	4.8	7.08	4.87	7.50	17.867	8.25	18.867
738	225.0 GPM – 3" Flange	4.46	—	7.26	4.8	7.08	4.87	7.50	17.867	8.25	18.867
740	300.0 GPM – 4" Flange	5.49	—	8.24	4.8	8.11	4.87	9.00	18.562	10.00	19.696
742	375.0 GPM – 4" Flange	5.49	—	8.24	4.8	8.11	4.87	9.00	18.562	10.00	19.696
744	450.0 GPM – 4" Flange	5.49	—	8.24	4.8	8.11	4.87	9.00	18.562	10.00	19.696

Order Number	Full Scale Flow SCFM - Air	FNPT	Dimension (Inches) FNPT Connections						150 # Flange		300 # Flange	
			A	B	C	D	E	F	G	H	G	H
707	4.0 SCFM	1/2"	1.30	11	4.32	4.8	3.92	4.87	3.50	13.125	3.75	13.625
709	8.0 SCFM	1/2"	1.30	11	4.32	4.8	3.92	4.87	3.50	13.125	3.75	13.625
711	16.5 SCFM	1/2"	1.30	11	4.32	4.8	3.92	4.87	3.50	13.125	3.75	13.625
713	24 SCFM	1/2"	1.30	11	4.32	4.8	3.92	4.87	3.50	13.125	3.75	13.625
715	20 SCFM	1"	1.88	13.24	4.86	4.8	4.50	4.87	4.25	16.75	4.88	17.500
717	42 SCFM	1"	1.88	13.24	4.86	4.8	4.50	4.87	4.25	16.75	4.88	17.500
719	76 SCFM	1"	1.88	13.24	4.86	4.8	4.50	4.87	4.25	16.75	4.88	17.500
721	100 SCFM	1"	1.88	13.24	4.86	4.8	4.50	4.87	4.25	16.75	4.88	17.500

### DIMENSION DIAGRAM

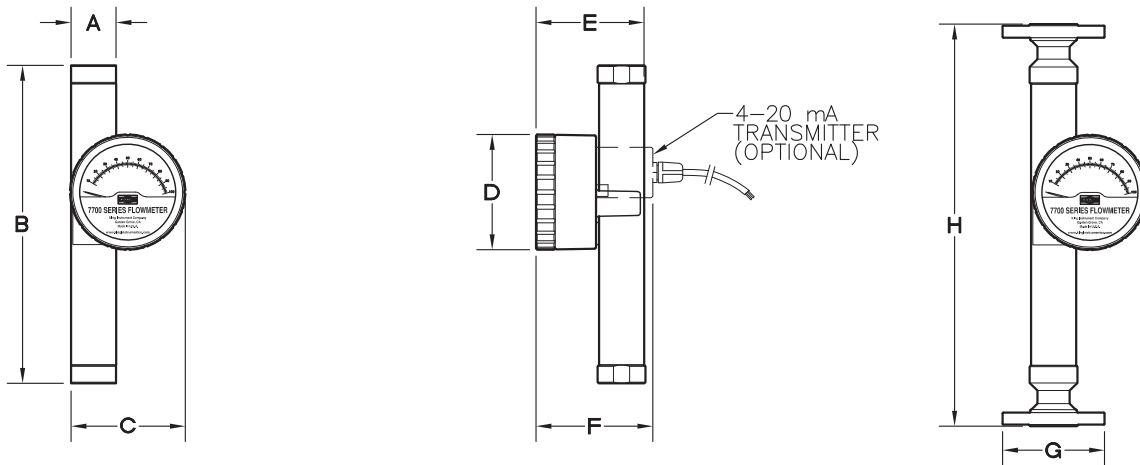

### ORDERING:

Use the following guide to determine the specific product number you require.

Meter Series	Connection Type	Float Material	O-ring Material	Optional Alarm/Transmitter	Order Number
771	FNPT Connections - 1	316L SS - 2	EPR - 1	None - 0	See Specifications table
	150# R.F. Flanged - 2		Buna-N - 2	With Transmitter - T	
	300# R.F. Flanged - 3		Viton® - 3	One Alarm (Inductive Slot Sensor) - A	
	600# R.F. Flanged*		Kalrez® - 4	Two Alarms (Inductive Slot Sensors) - D	

\*Call factory for 600# R.F. flange availability