

Model Number Chart

See Example Below



Panel Mount
Acrylic Rotameters

FR	Base Model Number
Code	Flow Range (from table below) A = Air L = Water
Code	Fitting / Valve Material
B	Brass
S	Stainless Steel
Code	Needle Valve
N	No Valve
V	Inlet Valve
Code	O-Ring Material
BN	Buna-N (standard with brass)
VT	Viton (standard with stainless steel)

FR 2A04 S V VT ◀ Typical Model Number

Features

- Durable solid one-piece clear acrylic construction
- Threaded brass inserts (10 - 32) for easy surface or panel mounting
- Clear, easy to read scales
- Superior valve design - valve stem cannot be backed out of valve body

Materials of Construction

Part	Standard	Optional
Meter Tube (Body)	Clear Polished Acrylic	
Fittings	Brass	Stainless Steel
Valves	Brass	Stainless Steel
O-Rings	Buna-N	Viton
Floats	Black Glass, Stainless Steel	

Maximum Pressure and Temperature

Maximum Pressure	Maximum Temperature
100 PSIG @ 70°F	150°F @ 0 PSIG

Scale Length	1½" to 2"
Connection Size	⅛" FNPT
Accuracy	+/-5% of Full Scale

Flow Ranges

Range Code	Flow Rate H ₂ O (70°F)	Range Code	Flow Rate H ₂ O (70°F)	Range Code	Flow Rate Air (STP)	Range Code	Flow Rate Air (STP)
	CCM of Water		USGPH of Water		SCFH of Air		SLPM of Air
2L09	5 - 50	2L28	.2 - 2	2A00	.1 - 1	2A12	.04 - .5
2L10	10 - 100	2L19	.4 - 5	2A01	.2 - 2	2A13	.1 - 1
2L11	20 - 240	2L20	1 - 10	2A02	.4 - 5	2A29	.2 - 2.5
		2L21	2 - 20	2A03	1 - 10	2A14	.4 - 5
		2L22	4 - 40	2A04	2 - 20	2A15	1 - 10
				2A05	3 - 30	2A16	2 - 25
				2A06	4 - 50	2A17	4 - 50
				2A07	10 - 100	2A18	10 - 100
				2A08	20 - 100		

Dimensions

A	B	C	D	E	F	G
4"	3"	1"	1⅝"	1⅜"	1⅛"	⅛"

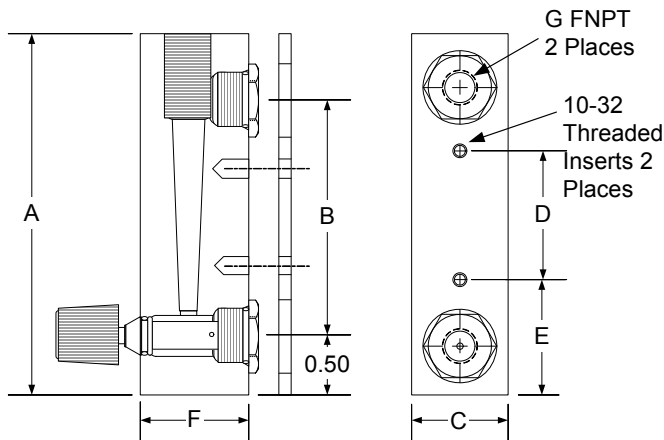

Also Available from Muis Controls



High Flow 7200 Series
Acrylic Rotameters



FR4000 Series
Acrylic Rotameters
with 4" Scale

Muis Controls Ltd. - Flow Meters - Flow Controls

29 Riel Drive, St. Albert, AB, Canada T8N 5C6
Ph +1-780-459-7080 Fx +1-780-459-7085 Toll Free 1-800-661-8823
www.muiscontrols.com info@muiscontrols.com